

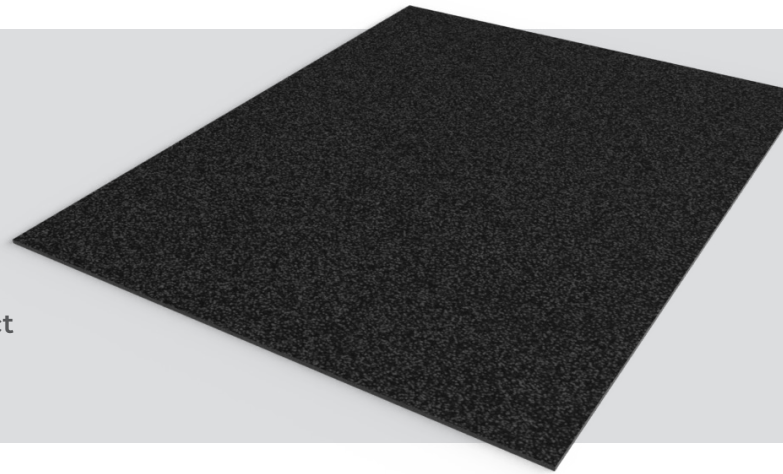

# TEKRUBBER

A cost-effective rubber bound resilient layer product manufactured from 100% recycled materials.



## OVERVIEW

Approved for use under the Robust Detail scheme to Part E compliance, TEK RUBBER is the ideal solution for controlling impact and airborne sound in all types of residential projects, including: apartments, student blocks and care homes.

TEKRUBBER is suitable for both sand/cement and proprietary flowing screeds and can be used with underfloor heating systems.

## TECHNICAL DATA

Sheet length	2250mm
Sheet width	1150mm
Sheet thickness	5mm
Density	755Kg/m <sup>3</sup>
Tensile strength (DIN 53571)	Approx. 0.55N/mm <sup>2</sup>
Thermal conductivity	Approx. 0.14W/mK
Elongation at break	Approx. 78%
Temperature resistance	-40°C to +115°C

## BENEFITS

- Perimeter strips not required, saving time and labour costs
- Offers long-lasting performance without collapse or "bottoming out" under high point loads
- Supplied in single sheets - 2.25m x 1.15m x 5mm
- Quick and easy to install: less than 10Kg per sheet
- A polythene layer is not required where sand/cement screeds are used
- MF ceiling perimeter isolation is not required
- 100% recyclable. Zero OPD and GWP

## WARNING

Whilst the information provided in this datasheet is true and accurate to the best of our knowledge, it may contain information which is unsuitable under certain circumstances since materials, site conditions and method of application vary with each application.

TEKCEM LTD cannot be held responsible for any loss or damage due to incorrect use or from the possibility of variations in working conditions and/or workmanship beyond our control. The user alone is responsible for any consequences deriving from the product.

## INSTALLATION GUIDE:\*

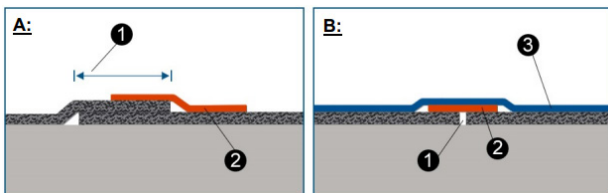

### FOR USE WITH DPM - FREE FLOWING SCREEDS

#### A: 65mm (min) sand/cement screed

1. TEK RUBBER to be overlapped by 50mm (min)
2. TEK RUBBER edge joints to be sealed with tape

#### B: 40mm (min) proprietary screed

1. TEK RUBBER joints to be butt jointed
2. TEK RUBBER joints to be sealed with tape
3. 500 gauge (min) polythene layer to be laid over whole floor, overlapping all joints

### FOR USE WITH SAND / CEMENT SCREED ONLY

1. Structural floor:
  - 150mm (min.) precast concrete plank
  - 300mm Kg/m<sup>2</sup> (min.) mass per unit area
2. TEK RUBBER resilient layer
3. TEK RUBBER edge joints to be sealed with tape
4. 65mm (min.) sand / cement screed - OR - 40mm (min.) proprietary screed of nominal 80kg/m<sup>2</sup>
5. Isolate skirting and wall lining from screed
6. Ceiling

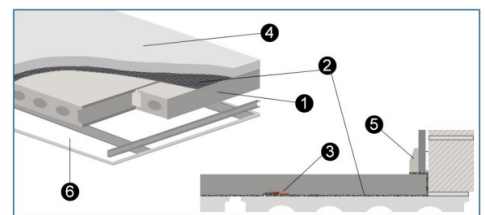

## MATERIAL

TEKRUBBER is manufactured from 100% recycled rubber and is supplied in 2.25m x 1.15m x 5mm sheets.

### IMPORTANT INFORMATION

- Butt planks tightly together
- Grout all joints between planks
- Fill all voids between wall and floor
- Ensure resilient layer is laid over entire floor surface with a min
- 100mm upstand at perimeter walls
- Ensure that TEKRUBBER branding is printed on the resilient layer material
- All joints must be taped using TEKCEM Single Sided Tape
- Ensure correct blocks are used in construction of external (flanking) walls.
- Ceiling treatment should be installed in accordance with manufacturer's instructions (where applicable).

## TOOLS REQUIRED

- A standard utility knife
- Battery powered tools can also be used

## SURFACE PREPARATION

The base floor must be clean, dry and free from loose dirt and concrete dust.

The floor must be flat (within National Building Standards +/- 5mm over a 5mm span).

## USE OVER CONCRETE SLAB/UNDER CHIPBOARD

### Where TEKRUBBER is installed on top of a slab:

TEKRUBBER should be installed butt jointed. Bonding with an adhesive such as REGUPOL REGUBOND is recommended when the material is used as an underlayment over a concrete floor.

When installed under chipboard, the material must be lapped up around the chipboard to prevent noise flanking into walls.

Chipboard should be laid in a bonded brick pattern with joints sealed with a weatherproof PVA such as EVERBUILD 502.

## STORAGE & SHELF LIFE

TEKRUBBER should be stored out of direct sunlight in cool, dry, frost-free conditions.

## SURFACE PREPARATION

1. Lay the sheets of TEKRUBBER directly on to the concrete subfloor, making allowance for the minimum 100mm upturn at all perimeter edges.
2. Sheets must be cut using a sharp craft knife or similar tool and a straight edge.
3. Sheets must be fitted into all internal and external corners with accurate cuts made to complement.
4. **When using a sand/cement screed** - ensure all joints are overlapped by a minimum of 50mm and tape all joints using TEKCEM Single Sided Tape.
5. **When using a proprietary flowing screed** - all joints are to be butt jointed and taped using TEKCEM Single Sided Tape.
6. TEKRUBBER sheets must be turned up at all perimeter edges to ensure that the screed does not come into direct contact at any point with the separating/party walls. The upturn should be of sufficient length to lap under all wall linings and skirtings.  
*Recommended upturn should be a minimum 100mm.*  
It is important that all penetrations through the screed such as soil pipes, columns, etc. are also isolated from the screed in the same manner.
7. All exposed joints on the vertical upturns must also be taped with TEKCEM Single Sided Tape.

### 8. Of vital importance:

It is essential that the area to be screeded is checked for any exposure of the subfloor and that all sheets of TEKRUBBER and polythene (polythene is only applicable when proprietary free flowing screeds are used) remain undamaged and that all joints are taped. Careful assessment at this point is imperative.

## PROPRIETARY & FREE FLOWING SCREEDS

### For proprietary and free flowing screeds ONLY:

When using a proprietary, free flowing screed, a polythene sheeting of minimum 500 gauge must be laid over the entire floor area ensuring that any overlapped joints are taped. It is also imperative that the polythene sheeting is taken up at all perimeter edges and covers the TEKRUBBER resilient layer in its entirety.

## HEALTH & SAFETY

This product is not classified under the Chemicals Hazard Information and Packaging for Supply Regulations. A material safety data sheet relating to this product can be obtained from TEKCEM LTD. Please dispose of packaging and waste responsibly.