

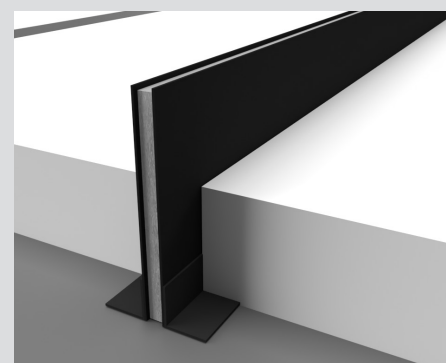

CONTROL JOINT

A Vertical Control Joint provides a simple way to form designed movement joints or day joints.



OVERVIEW

TEKCEM CONTROL JOINTS are designed for forming joints for designed movement, reflected structural joints or movement day joints.

TEKCEM CONTROL JOINTS have a peel off self adhesive at the base, enabling simple fixing.

TEKCEM CONTROL JOINTS are supplied in 1.8m strips so that one strip will usually be sufficient for two door thresholds.

TECHNICAL DATA

Length	1800mm
Thickness	10mm
Height	30mm, 40mm 60mm, 80mm, 100mm
Colour	Black/Red
Pack size	30mm - 25 lengths per box
	40mm - 25 lengths per box
	60mm - 25 lengths per box
	80mm - 25 lengths per box
	100mm - 20 lengths per box

INSTALLATION CONSIDERATIONS

TEKCEM CONTROL JOINTS can be used over any substrate for which the chosen screed is suitable.

When using a TEKCEM CONTROL JOINT to form a day joint, it may be necessary to temporarily "back" the joint with sand or timber to provide support while screed is laid to the opposite face.

The use of TEKCEM CONTROL JOINTS in this way is only necessary where the requirement for a movement joint coincides with a day joint.

TEKCEM CONTROL JOINTS can be cut to allow a route for conduits or under floor heating pipes etc.

HEALTH & SAFETY

This product is not classified under the Chemicals Hazard Information and Packaging for Supply Regulations. A Material Safety Data Sheet relating to this product can be obtained from TEKCEM LTD Please dispose of packaging and waste responsibly.

WARNING

The information provided in this datasheet corresponds to the best of our expert knowledge and experience. Whilst it is true and accurate to the best of our knowledge, it may contain information which is unsuitable under certain circumstances since materials, site conditions and method of application vary with each application. TEKCEM LTD cannot be held responsible for any loss or damage due to incorrect use or from the possibility of variations in working conditions and/or workmanship beyond our control. The user alone is responsible for any consequences deriving from the product.